

# ZVAA Series

## Pneumatic Control Valve



UNIVERSAL

### Features

- ◇ 2 position 2 port reversing valve (normally open) with G1/8 and G1/4 air supply ports returns the air signal through the vacuum switch to realize the air supply opening and closing to save energy
- ◇ The small valve can control high flow compressed air



### How to order

## ZVAA - G1F

① ②

① Series	② Connection thread
ZVAA	G1F - G1/8 female thread G2F - G1/4 female thread

### Technical parameters

Model	Air supply pressure bar	Valve body material	Output function	Working temperature °C	Weight g
ZVAA-G1F	3.5~7.0	Aluminum alloy	NO	0~60	45
ZVAA-G2F	3.5~7.0	Aluminum alloy	NO	0~60	125

### Dimensions (mm)

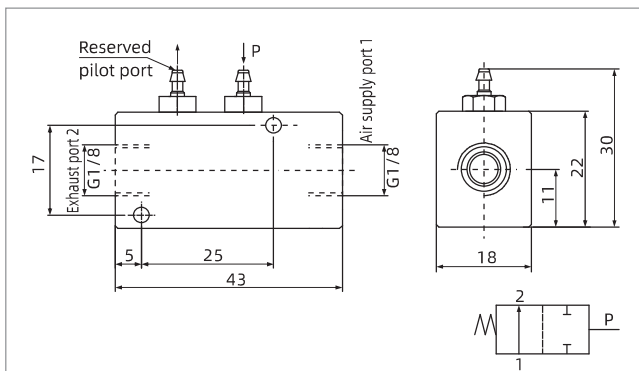

ZVAA-G1F

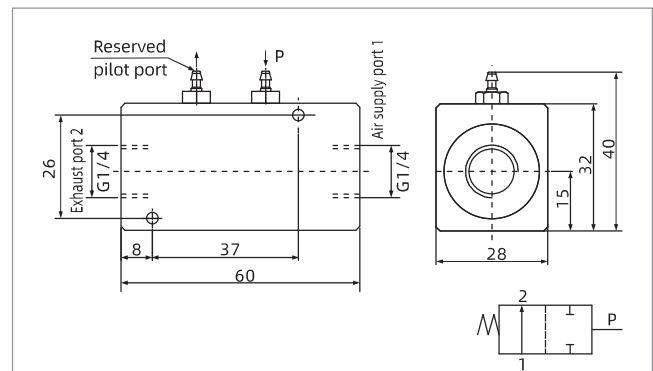

ZVAA-G2F