

ZVRM Series

Check Valve



UNIVERSAL

Features

- ◇ Effectively avoid the influence to the whole vacuum system when the suction cup failed to adsorb the workpiece
- ◇ In the same vacuum system, workpieces of different sizes can be repeatedly grasped
- ◇ Spring type check valve helps to prevent workpiece from dropping in turnover movement



How to order

ZVRM 07 - M5M

① ② ③

① Series	② Overflow port diameter	③ Suction cup connection thread
ZVRM	03 - ϕ 0.3mm 05 - ϕ 0.5mm 07 - ϕ 0.7mm 10 - ϕ 1.0mm	M5M - M5x0.8 male thread G1M - G1/8 male thread

Selection

Model/Thread M5M	G1M
ZVRM03-M5M	-
ZVRM05-M5M	ZVRM05-G1M
ZVRM07-M5M	ZVRM07-G1M
-	ZVRM10-G1M

Technical parameters

Model	Overflow port diameter mm	Valve core works Effective cross-sectional area mm ²	Valve core doesn't work Effective cross-sectional area mm ²	Fluid	Max. pressure range kPa	Removal efficiency μ m	Minimum action flow NL/min	Weight g
ZVRM03-M5M	0.3	0.07	1.64	Air	-100~0	40	2	6
ZVRM05-M5M	0.5	0.19	1.76	Air	-100~0	40	4	6
ZVRM07-M5M	0.7	0.38	1.95	Air	-100~0	40	5.5	6
ZVRM05-G1M	0.5	0.19	1.76	Air	-100~0	40	5	22
ZVRM07-G1M	0.7	0.38	2.64	Air	-100~0	40	8	22
ZVRM10-G1M	1.0	0.78	3.04	Air	-100~0	40	16	22

ZVRM Series

Check Valve



Dimensions (mm)

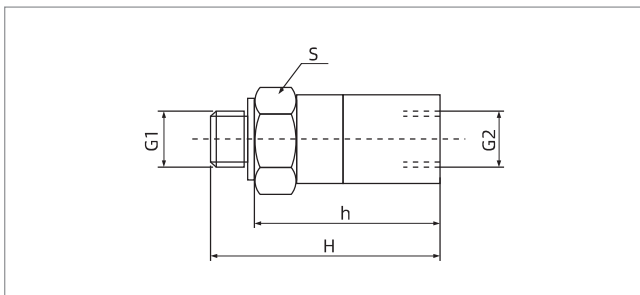

ZVRM

Model/Size	H	h	G1	G2	S
ZVRM03-M5M	20	16	M5×0.8depth3.5	M5×0.8depth6	8
ZVRM05-M5M	20	16	M5×0.8depth3.5	M5×0.8depth6	8
ZVRM07-M5M	20	16	M5×0.8depth3.5	M5×0.8depth6	8
ZVRM05-G1M	28.5	23	G1/8depth5	G1/8depth8.5	13
ZVRM07-G1M	28.5	23	G1/8depth5	G1/8depth8.5	13
ZVRM10-G1M	28.5	23	G1/8depth5	G1/8depth8.5	13